

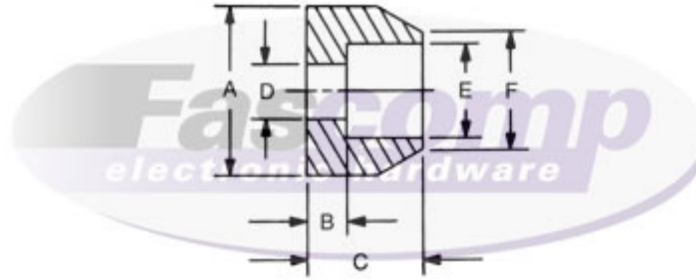

# Ferrules Type 1



**Create a part number:**

<b>Length</b>	<b>Material</b>	<b>Finish</b>
FCXXXX	XX	XX
<hr style="border: 0; border-top: 1px solid black; margin: 5px 0;"/>		

Part Number							
✓	FCXXXX	A +.005 -.005	B +.005 -.005	C +.005 -.005	D +.005 -.005	E +.005 -.005	F +.015 -.015
	FC8972	1/4	.046	.125	.116	.136	13/64
	FC8973	1/4	.046	.125	.116	.161	13/64
	FC8974	5/16	.062	.125	.141	.203	17/64
	FC8975	3/8	.062	.125	.141	.260	5/16
	FC8976	3/8	.062	.187	.204	.260	5/16
	FC8977	7/16	.062	.187	.204	.260	5/16
	FC8978	1/2	.062	.250	.187	.260	11/32
	FC8979	15/32	.062	.250	.221	.320	13/32
	FC8980	9/16	.062	.250	.221	.320	13/32
	FC8981	5/8	.093	.375	.250	.385	15/32
	FC8982	3/4	.093	.375	.315	.515	39/64

Material	
✓	Material Code (XX)
	A Aluminum
	B Brass
	S Steel
	SS Stainless Steel

✓	Compatible Finish	
	A, B, S, SS	0 - Plain
	B, S	5 - Nickel Plate (QQ-N-290)
	A	6 - Iridite #14 Gold (MIL-C-5541E)
	A	7 - Iridite Clear (MIL-C-5541E)
	A	9 - Alodine 1200
	B, S	12 - Zinc Clear (ASTM-B-633)
	B, S	16 - Electro Tin (MIL-T-10727 TYPE 1)
	SS	20 - Passivation (MIL-F-14072D)
	A	22 - Clear Anodize (MIL-A-8625-TYPE2) (Sulphuric) Hot Water Seal (Clear)
	A	24 - Black Anodize (MIL-A-8625)
	B, S, SS	26 - Black Oxide
	B, S	28 - Zinc Yellow (ASTM-B-633)

**Tolerances  
Unless otherwise Specified**  
 .xxx +/- .005  
 .xx +/- .010  
 Angular +/- 1 Degree  
 Linear +/- .005  
**Break all sharp edges**



Source Control Drawing:  
To be produced by  
Fascomp Electronic Hardware

This document is the  
property of Fascomp Inc. and shall not be  
reproduced, distributed or used as a basis  
for manufacturing without written  
permission from Fascomp Inc.